

play & sound[®]

WALL RADIO

AIR RADIO

41515

41513

41020

41518

41517

41018

41019

41514

en user's manual

41515 Bluetooth® control unit with AUX/TV and PIN

Function

The sound unit must be connected to a mains voltage between 115 and 230 V~ 50 / 60Hz, prior to being used.

The sound unit remains at OFF/Standby state when powered for the first time or after a power failure (even if it was ON before).

Even with the sound unit in ON position, if it suffers a blackout of power grid, at the return of the mains supply the sound unit mode, always stays on OFF or stand-by position.

To obtain the best sound quality, check speaker connections before turning on the device (no short-circuits, correct polarity and minimum impedance).

First connection

1. Press key to turn on the sound unit for the first time.

Bluetooth® mode will be selected and the **blue led** will start to blink quickly.

That means it's ready to be paired with other device.

If the paired device list is empty, the sound unit will blink quickly.

If the sound unit has a previous link with other device (i.e. Paired Device List is not empty), it will blink slowly.

Audio source selection and volume level are stored when the device is turned off. In case of power failure, it will return to Bluetooth mode when turned on.

NOTE: When the sound unit is at bluetooth® mode and visible/pairable, it's displayed to other devices as "EGi PS WR xxxx". Paired device list is empty when the sound unit comes from factory. The unit can store up to 8 paired devices.

A short press on key will make the sound unit visible/pairable, so that a new device can be paired with it.

When the Paired Device List is full, the oldest connection device (i.e. the least used) will be erased from it, and replaced for the new one (see paragraph 2.).

2. If key is pressed, the blue LED will blink quickly. It shows that the sound unit is visible for other bluetooth® devices, and therefore can be paired with any bluetooth® audio source..

Once paired with a new device, the audio unit stores its data in the paired device list. Then the blue led will light continuously and the unit will be playing audio indefinitely until it is turned off, another audio source is selected, the user disconnects it manually, or maximum distance between the unit and the device is exceeded.

3. When key is pressed, the sound unit will go to bluetooth® mode, regardless of its previous state. Blue LED will blink slowly and the unit will try and reconnect to the last connected Bluetooth device. If it fails, it'll try to reconnect with the following device from the paired device list, and so on until it reaches the end of the list. Press twice the ON/OFF key to force a new search .

If the device is disconnected by the user or by exceeding the maximum distance, the blue led will start to blink slowly. That means that the unit can be connected to any device of the paired device list.

NOTE: To clear paired device list, please hold the key pressed for 6 seconds.

Normally it is not necessary, because every time a new device is paired, the unit erases the least used device from the list to store the new one.

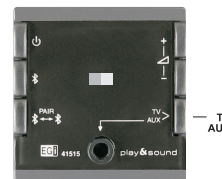
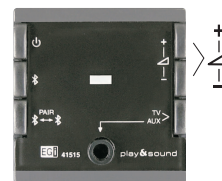
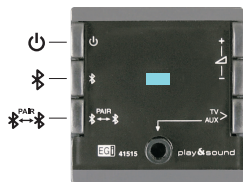

4. Volume is controlled by and keys. It has 32 steps of 2dB each one.

Volume is set from factory to a medium level.

The unit memorizes the volume level selected by the user, so that it is restored when the unit is turned on.

However, after a power failure, the volume level is restored to its factory setting.

NOTE: Remember that bluetooth® devices have an independent volume control. Therefore, we recommend adjusting unit volume near to its maximum and using device volume control. This way, maximum performance is achieved while the user has a more comfortable volume control.

5. By pressing **TV > AUX** key, the unit switches from bluetooth® to TV mode. Audio from rear connection is selected and **led** changes to **green**.

Then, if **TV > AUX** key is pressed again, the unit will switch to **AUX** mode. Audio from front 3.5mm jack will be selected and **led** will change to **yellow**.

If **TV > AUX** key is pressed again, **TV** mode will be selected and so on.

6. Priority audio input (**PIN**) is activated **ONLY** by a Millennium signal. It consists of a +3 V~ audio level superimposed to a +7 V~ level (referred to **GND**).

Regardless of the control unit state (ON, OFF, bluetooth®, TV or AUX), if **PIN** input is activated, audio from this input will be selected, **led** will switch to **red** and volume control will go to maximum level. This unit will remain at this state until **PIN** input is deactivated, returning to its previous state.

We recommend the use of MILLENNIUM equipment (1308.1, 1310.1 or 1304.1A) to utilize this function.

Troubleshooting

Problem

- The sound unit doesn't turn on.
- The sound unit turns on, but there's no sound.
- The blue led blinks slowly, but the unit doesn't connect with a paired device.
- The unit is at TV or AUX mode, and there's no sound.

Possible solution

- Check if the sound unit is powered. A voltage between 115 and 230 V~ 50/60Hz must be applied to **L** and **N** terminals.
- Check that the speakers are properly connected to **L+ / L-** and **R+ / R-** outputs. Verify the absence of short-circuits and check that line impedance is above 11 ohms. Make sure that a bluetooth® device is connected, or a signal is present at TV or AUX inputs. Set volume level to maximum.
- Check that your device has Bluetooth connectivity enabled. Press twice the ON/OFF key to force a new search through the paired device list . To force a pairing process, press key.
- Verify that an analog signal with a level around 250-500 mV is present at TV (rear terminals) or AUX (front 3.5 mm jack) inputs.



WALL RADIO

play & sound

HIGH QUALITY SOUND

STEREO

RDS



Bluetooth®
USB - MP3

en user's manual

- 41513** Wall Radio FM/RDS module (with optional bluetooth®, input & USB)
41020 Wall Radio FM/RDS Kit (with bluetooth®, line input IN, USB & headphones)

Operation

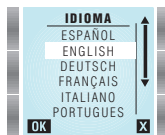
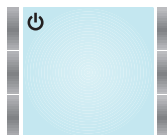

First connection

Press ON key .

Language selection menu appears.

Use and keys to select your language and press **OK**.

Or press to exit.

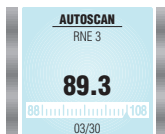

Autoscan

Once language is chosen, autoscan process begins. It performs an automatic search for the FM* stations with best reception and obtains RDS data (this operation can take up to 2 minutes approximately).

(*) Up to 30 stations + 6 in manual mode.

Autoscan process can be done at any time by entering MENU and selecting AUTOSCAN.

Main screen

Turn on/off the device

Press key to turn on/off the device.

When the module is off, backlighting intensity can be adjusted by means of and keys. It affects only to the backlighting when the module is off.

It affects only to the backlighting when the module is off.

NOTE: In case of power failure, when the module is turned on again, RADIO mode will be selected.



Volume adjustment

When the module is on, volume level can be adjusted by means of and keys.

A short press changes the volume step by step, whereas a long press changes it at an accelerated rate.

NOTE: This function is available when an audio source is activated and its main screen is displayed.



FM List

Press **FM** key to see all tuned stations.

Use and keys to select a station and press **OK** to listen to it. Normally, station name is displayed. If the station does not send RDS information, station frequency is displayed instead.

Press key to add stations to FAVOURITES list.

Press key again to remove a station from FAVOURITES list.

To remove a station from FM LIST, select it and press (REMOVE). It will be erased permanently.

To recover an erased station, it must be tuned later by using MANUAL FM.

Press key (EXIT) to quit menu at any moment.

Favourites list

Up to 6 favourite stations can be selected.

Press at FM LIST to choose them. Selected station will be added to favourites list at the first free location. A station can be added at FAVOURITES by using and keys to select a free location and then **FM** key. This way a list of available stations will appear, from which the desired station can be added to FAVOURITES .

To remove a favourite station from the list, select it using and keys and press key (REMOVE).

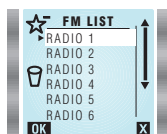

Main MENU (to enter it, press MENU)

NOTE: INPUT and BLUETOOTH functions are only available when a 41518 module is connected.

• TIME

Internal clock can be adjusted automatically (by synchronizing it to a station with RDS time information) or manually.

If AUTO mode is selected, time information will be restored automatically after a power failure.

Automatic setting:

From TIME menu select AUTO.

Press **FM** key and choose a station that offers RDS time information (usually state stations).

Wait 1 or 2 minutes for the clock to synchronize and press **OK**. If current time is not displayed, switch to other station.

Manual setting:

From TIME menu select MANUAL.

Use and keys to modify hours value (HOURS is highlighted).

Then, press key to adjust minutes the same way as hours. When all is correct, press **OK** key.

Once the clock is set, **OK** key will be replaced by key in TIME menu.

If key is pressed, time will not be displayed anymore.

12-24 hours mode:

To change time display mode, press key to highlight 12/24H.

Then press 12/24H to choose the desired option. Press **OK** to validate.

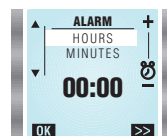
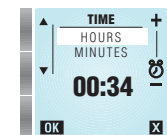
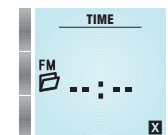
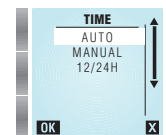
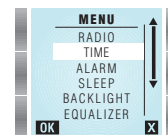

• ALARM

NOTE: Take into account that present FM station and volume level will be stored for ALARM function.

To set the alarm, highlight ALARM from main menu by using and keys and press **OK**.

Use and keys to modify hours value (HOURS is highlighted).

Then, press and keys to adjust minutes the same way as hours.

Press key (MORE) to select alarm type.

Alarm volume will be set at the same level that it was when configured.

By means of and keys, following options can be chosen: FM radio once , Buzzer once , FM radio every day or Buzzer every day .

When all is correct, press **OK** key.

Activation time and alarm type will be shown on main screen.

When alarm is triggered, it can be turned off by pressing STOP (stop alarm) or SNOOZE (repeat every 9 minutes).

If not turned off, alarm will stop after 10 minutes.

To delete the alarm, select ALARM from the main menu and press key.

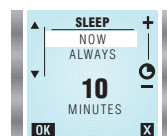
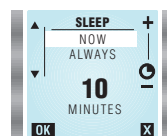

• SLEEP (TIMER)

To set the timer, highlight SLEEP from main menu by using and keys and press **OK**.

Use and to select whether the timer will be activated once (NOW) or every time the module is turned on (ALWAYS).

Use and keys to adjust turn off time.

Press **OK** to save the settings.

Select 0 minutes to deactivate SLEEP function.

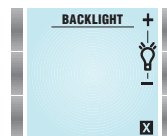

• LIGHTING CONTROL

Lighting when the module is on:

To adjust screen lighting level, highlight BACKLIGHT from main menu by using and keys and press **OK**.

Lighting level can be modified by using and keys. Press (EXIT) to save the setting.

Lighting when the module is stand-by:

Lighting level can be modified by using and keys.

When the module is off, the screen can be completely darkened.



• EQUALIZER

To adjust bass and treble, highlight EQUALIZER from main menu by using and keys and press **OK**.

Use and to select bass or treble .

Once selected, press or to increase or decrease bass or treble level.

When adjusted press **OK** to save and quit, or to quit without saving.

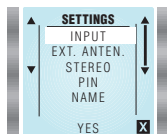
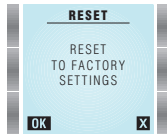
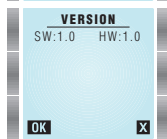
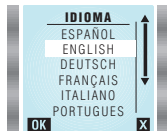
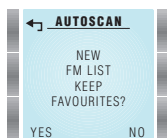
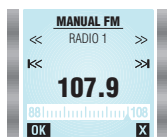

MANUAL FM

To tune manually a station, highlight MANUAL FM from main menu by using ▲ and ▼ keys and press **OK**.
Tuning frequency can be increased or decreased in 100 KHz steps by pressing ◀ or ▶.
To perform an automatic search, press ◀◀ or ▶▶ to find the next higher/lower frequency station (signal level must be over a certain threshold).
When a station is found (both in auto and manual mode), after some seconds RDS* information will appear.
Sometimes this information is changing, press **OK** when it is displayed the information you want to associate with the station. The station will be added to FM list (if there is any memory available).
It can be stored up to 36 stations (30 from autoscan + 6 from manual tuning).
(* Not all the stations transmit RDS information, If RDS text does not appear, press **OK**.)

AUTOSCAN

To activate automatic station search, highlight AUTOSCAN from main menu by using ▲ and ▼ keys and press **OK**.
A new FM station list will be created. Favourites list can be kept or deleted.
Autoscan process can take several minutes.
Press ▶ to quit without doing autoscan.

LANGUAGE

To select menu language, highlight LANGUAGE from main menu by using ▲ and ▼ keys and press **OK**.
Use ▲ or ▼ to select the desired language and press **OK**.

VERSION

To know device firmware version, highlight VERSION from main menu by using ▲ and ▼ keys and press **OK**.
It will appear: software version, serial number and other service information. (SW – stands for software version and HW – stands for hardware version).

RESET

To reset the system configuration to factory settings, highlight RESET from main menu by using ▲ and ▼ keys and press **OK**.
User will be prompted to confirm action (press **OK**) or to quit without executing reset (press **X**).
IMPORTANT: Personal configurations, FM list and Favourites list will be erased by resetting.

SETTINGS

To change the settings, highlight SETTINGS from main menu by using ▲ and ▼ keys and press **OK**.
Use ▲ and ▼ keys on the right to select the item to be modified.
Use ▲ and ▼ keys on the left to activate/deactivate the option.
EXT. ANTENNA:
Use ▲ and ▼ keys on the right to select EXT. ANTEN.
Use ▲ and ▼ keys on the left to select external antenna (YES) or internal antenna (NO).
Internal antenna is recommended.
Use an external antenna in case of mains interferences (caused by ballasts or switching power supplies).

STEREO:

Use ▲ and ▼ keys on the right to select STEREO.
Use ▲ and ▼ keys on the left to select stereo mode (YES) or mono mode (NO). Use mono mode when FM reception is poor.

RDS LIVE:

This function allows real time RDS information display.
Use ▲ and ▼ keys on the right to select RDS LIVE.
Use ▲ and ▼ keys on the left to activate RDS LIVE (YES) or to show only the station name (NO).

- To select the USB source, select USB from main menu.
- Once USB is selected, press **USB** to search the desired song in the folders and subfolders tree. Press ▶ to play it.

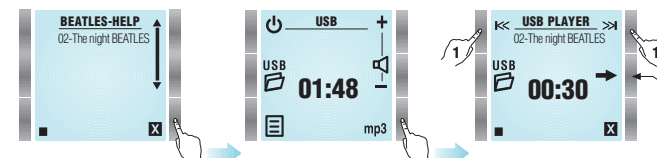

- Once the desired song is being played, exit folders screen by pressing **X** (EXIT). Press **mp3** key to enter the player screen.
- From this screen, audio tracks playing can be controlled.
- A short press on ◀ or ▶ keys, jumps to the previous or next audio track.
- If ◀ or ▶ keys are kept pressed, present audio track time is moved back or forward.

PLAY/REPEAT MODES (pressing ◀ → key)

- A** All the tracks in the present folder or directory are played indefinitely.
- 1** Present track is played indefinitely.

RND RANDOM o **SHUFFLE** - All the tracks in the USB memory (regardless their location in the folder tree) are played in a random order and indefinitely.

➡ All the tracks in the USB memory (regardless their location in the folder tree) are played indefinitely.

NOTE: When the word SEARCHING appears, it means that the module is looking for a USB memory stick or that it is not inserted.
When the symbol **X** appears, the module is searching for audio files "MP3" or "WAV".

Input

Prior to use this function, a device must be connected to 41518 module through the 3.5 mm jack input.

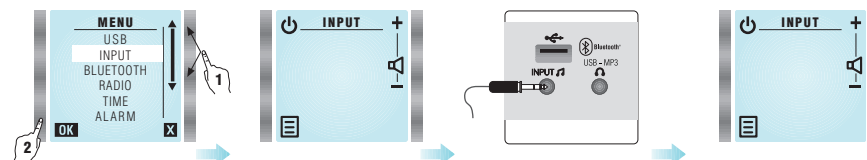

- To select the line input source, select INPUT from main menu.

Connection to 41518 module (USB, bluetooth® and line input + phones output)

Some menu elements can be shown or not depending on configuration and connected modules.

41518 module is controlled from 41513 module and when it is connected, some features are added to menu.

USB, Bluetooth® and line input sources can be activated from main menu (PHONES is activated when a jack is plugged in).

USB

An USB memory with audio files (MP3 or WAV) should be inserted in 41518 module inlet prior to use this function.

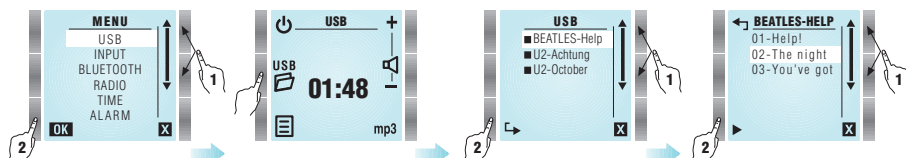

Phones

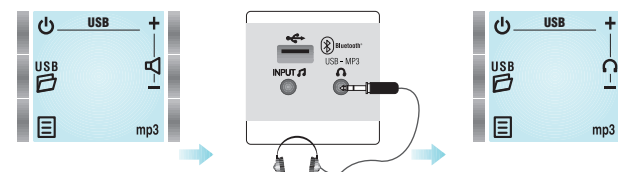

NOTE:
PHONES option can be activated from any audio source (USB, Radio, Bluetooth® and Input).
Sample screen shows USB case.

- To enter headphones mode PHONES, it is necessary to connect a 3.5 mm stereo plug to PHONES jack.
- Speaker outputs are automatically turned off. Volume level is switched to the last stored value at PHONES mode.
Press + / - keys to control volume.

Bluetooth®

IMPORTANT: It is recommended changing module Friendly Name and PIN prior to use Bluetooth®, in order to differentiate it from other nearby devices. Select **SETTINGS** from main menu to do it

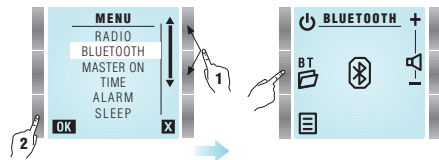

NOTE:

In case of power failure or if Bluetooth® mode is quit and re-entered quickly, it could take 14 seconds for the BLUETOOTH function to be available. In the meantime symbol will be displayed.

- When BLUETOOTH option is highlighted and set by pressing **OK**, the module activates Bluetooth® function and it becomes visible to other Bluetooth® devices.
- Device search can be done in two ways:
 - From the device that is going to transmit audio (smartphone, laptop, tablet...)
 - From the 41513 module by entering Bluetooth folder **BT**.
- Press **BT** key to display paired devices list.

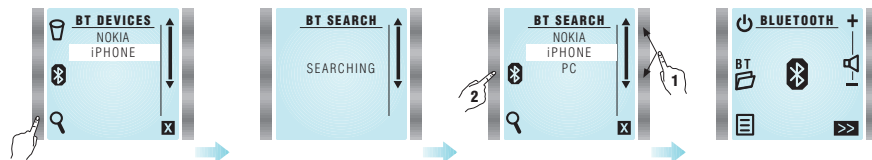

- Press **Q** to find new devices. They will be displayed after around one minute.
- Select the device to be paired with, and press **Q**.
- The paired device will ask for a PIN code. If it has not been changed, the value to be entered is printed on the module labels.

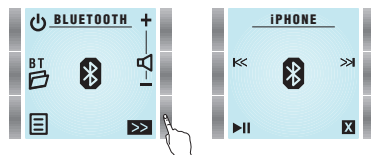

Bluetooth® connected.

Bluetooth® NOT connected.

- Once the Bluetooth device is connected, user will be able to listen to the music, to change volume or to control music playing. It can be done either from the device or from the module.
- When **>>** key is pressed, module enters remote player mode.
 - Press **▶** to jump to the next song.
 - Press **◀** to jump to the previous song.
 - Press **||** to play/pause the music.

- To unpair a device (i.e. delete it from paired devices list), enter **BT** (BT DEVICES), select the device to unpair with and press **Q** key. The pairing can be also deleted from the device (smartphone, PC, tablet, laptop...).
- Enter settings menu to change PIN.
- Module Friendly Name is factory preset to "EGi 41518 ____". "____" stands for a four digit unique identifier. These codes are printed on a label on the back of the module and on another loose label.
- Enter settings menu to change NAME.

Settings (only available when a 41518 is connected)

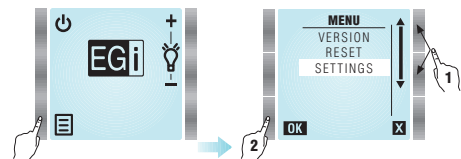

• SETTINGS

To change these 41518 module special settings, highlight **SETTINGS** from main menu by using **▲** and **▼** keys and press **OK**.

• PIN

This option allows changing BLUETOOTH® PIN. It is factory preset to the value printed on the labels, but it can be changed to any desired 4 digit code.

Highlight PIN from **SETTINGS** menu and press **OK**.

Use the 2 top keys on the left to select the digit.

Use the 2 top keys on the right to change the digit.

Press **OK** to validate the new PIN, or press **X** to quit without modifying it.

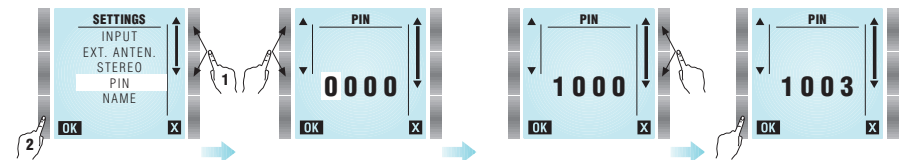

• NAME

IMPORTANT: It is recommended to perform this operation prior to activate Bluetooth®.

This option allows changing BLUETOOTH® Friendly Name. It is factory preset to "EGi 41518 ____", but it can be changed to any desired name (up to 14 characters).

Highlight NAME from **SETTINGS** menu and press **OK**.

It will appear a list with suggested names that can be assigned to the module. The module current name is at the top of the list.

Any name is editable by selecting it and pressing **OK**.

Use the 2 top keys on the left to select the character.

Use the 2 top keys on the right to change the character.

Press **OK** to validate the new NAME, or press **X** to quit without modifying it.

NOTE: It is recommended to change Friendly Name and PIN before pairing the module with any Bluetooth® device, so they are displayed correctly. If module Friendly Name is not updated in a Bluetooth® device, please delete the module from the device Bluetooth list and re-pair it.

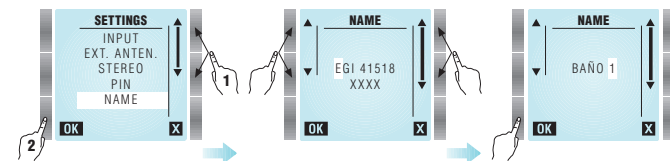

Troubleshooting

Problem

- Module doesn't work. The screen is off.

- The screen is on, but there is not any sound.

- Band FM reception.
(41513 module uses mains cable as antenna. In case of interferences or weak signal, please connect an external antenna and change antenna selection in **SETTINGS** menu accordingly).

- A bluetooth® device is not seen from the module.

- Time is not recovered automatically after a power failure. It shows blinking dashes instead of the time.

- Time is not displayed on the screen.

Possible solution

- Press any key to get a response.
- Check mains connection.

- Check that a valid audio source is selected and it is playing some music.
- Check volume level is not at minimum.
- Check that the speakers are properly connected to the connection block.

- Connect an external FM antenna by using coaxial cable or check that it is properly connected.
- Check antenna settings to see if antenna selection is correct.
- Ensure that the module is not close to electronic ballasts or similar equipment (fluorescent lamps...).

- Check that the device has bluetooth® function enabled and it is configured as visible to other devices.

- Check that time is configured to AUTO mode and a valid FM station is selected (it must transmit time information by using RDS).
- Configure time settings to AUTO mode, so it can recover time information automatically after a power failure.

- Check that TIME is not disabled.
- Set the clock in manual or auto mode.



WALL RADIO 41518

play & sound®
HIGH QUALITY SOUND STEREO USB-MP3 Bluetooth®

en user's manual

41518 Auxiliary module for Wall Radio 41513 with line IN, USB, headphone and bluetooth®.

Operation

Activation

By connecting 41513 module to a 41518 module, the following additional audio sources will become available in main menu : USB, INPUT and BLUETOOTH.

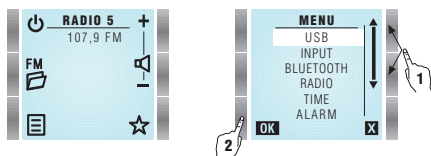

• USB

USB socket is intended to connect memory devices whose consumption is below 100 mA. It can play MP3 and WAV files stored in the memory. Enter MENU and select USB to activate this function.

• INPUT

Enter MENU and select INPUT to activate audio input socket. Any line level signal can be connected to it from MP3 players, walkman®, discman, PCs, tablets or smartphones.

• BLUETOOTH

Enter MENU and select BLUETOOTH to activate bluetooth® connectivity. To obtain the bluetooth® friendly name and the PIN code, read the back label, from the back side of the 41518 module.

• HEADPHONES

Headphones output is automatically activated when a jack is plugged in PHONES socket. Speaker outputs are switched off. Volume level goes to the last stored headphones volume level. Unplug the jack to listen from the speakers again.

For more information about operation, please read the following chapter from 41513 user manual: **Connection to 41518 module.**



AIR RADIO 41517 41018 41019

play & sound®
HIGH QUALITY SOUND STEREO multiroom Bluetooth®
RDS

en user's manual

41517 Amplified master module with bluetooth® connectivity, FM/RDS, audio input and multiroom

41018 XS Kit audio bluetooth® for rooms of 30 sq m

41019 XS Kit audio bluetooth® for rooms of 20 sq m

Note

Remember that in addition to operating only in Bluetooth mode, to get maximum performance with FM, multiroom, clock, alarm and INPUT; we recommend to acquire the remote control 41514.

The sound unit must be connected to a mains voltage between 115 and 230 V~ 50/60Hz, prior to being used.

Because these devices communicate by radio frequency, depending on the environment interference and objects, communication can be altered.

There is not any LED indicator, so it is necessary to connect at least one speaker (better two) in order to check the unit is working properly.

External audio amplifiers (i.e. E17G/D, 40425 & 40430) can be attached to the audio output. To do so, connect 41517 terminals **L+**, **R+** & **4(GND)** to the audio amplifier input terminals **+L**, **+R** & **GND** respectively.



Operation in Bluetooth® mode only without remote control

First connection

41517 master module works in Bluetooth® mode only when powered for the first time or after a blackout. Initial state is stand-by: the module is visible to any Bluetooth® device and can be paired with it.

Module Friendly Name is "EGi 41517 xxxx". This name will appear on the Bluetooth® device screen when searching. EGi is the brand, 41517 is the product reference and "xxxx" stands for the last four digits of the serial number.

Every module has a unique Friendly Name, so the user can know which module is connecting to. Friendly Name is printed on two labels: one is attached to the enclosure, and the other one is left loose into the packaging.

Pin code linking

A 4-digit random **password / PIN** code is printed on the labels. It must be keyed in during linking process.

Once linked and connected, the module will start to sound.

WARNING: Please don't lose the labels so that the **Friendly Name** and the **PIN** code are always available.

Turning ON

The module remains in stand-by state until it is connected to a Bluetooth® device.

When connected, it goes to **ON** state: audio output is activated, volume is adjusted to its preset value and equalizer is set to achieve optimum performance. Since then, volume control and music selection will be controlled from the linked Bluetooth® device.

NOTE: Disconnection causes are: manual command from the device or lost of coverage.

When disconnected, module goes to stand-by state: audio output is disabled and the module is visible/connectable again. In other words, it can be linked to a new Bluetooth® device or connected to a known device (one that has been linked previously).



Access to **LINK** internal key on the back side of 41517.

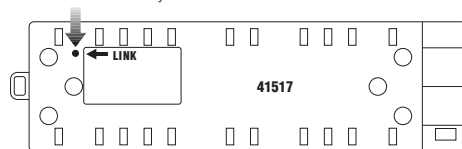

Preset volume adjustment

Preset volume is factory-set at maximum level. However, it can be changed and limited by means of **LINK** key, which is located on the back side of 41517 module. Every short press on **LINK** key reduces preset volume in -6 dB steps up to -68 dB, and then it goes to maximum level again.

Once adjusted, preset volume is stored and its value is kept even in case of power failure. It can be adjusted again or be reset to factory-set value (maximum) by pressing **LINK** key for 6 seconds or more.

WARNING: Keep in mind that a RESET can modify other parameters.

NOTE: In Bluetooth® mode, the user can control volume level from the device. We suggest leaving the volume of 41517 module at maximum level. This way maximum performance can be obtained and the control is more comfortable.

Volume / Link / Reset key

LINK key has three functions:

1. Every short press on **LINK** key reduces preset volume in -6 dB steps up to -68 dB, and then it goes to maximum level again.
2. Additionally, a short press on **LINK** key makes the module visible for Zigbee devices, so that it can be linked with a 41514 remote control.
3. A long press (more than 6s) produces a RESET of the module: preset volume is set to maximum, Friendly Name and PIN code return to the value printed on the labels.

Operation in full-functionality mode: Bluetooth, FM/RDS, aux. input & multiroom using EGi remote control

First connection

41517 master module works in Bluetooth®-only mode when powered.

It is necessary to link it to one or more 41514 remote controls to get full functionality: FM/RDS, multiroom, aux. INPUT, clock, alarm, sleep and equalizer.

Access to **LINK** internal key on the back side of 41517.

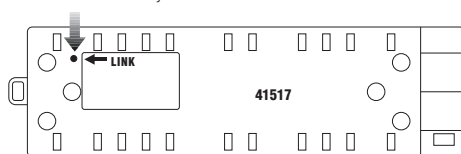

Linking to a 41514 remote control

Master module can be controlled by one or more 41514 remote controls, so that several people can control it. A 41514 remote control can handle up to five 41517 modules. A 41517 module can be handled by up to fifteen 41514 remote controls.

Communication between 41517 modules and 41514 remote controls is performed by Zigbee. It is a radiofrequency communications protocol.

- To link the devices, please press **LINK** key on the back side of 41517 module (so it becomes visible for Zigbee devices). Next, press the two upper-right  keys on the 41514 remote control at the same time (**LINK TO A NEW RECEIVER**). It will appear "LINKING" on the screen. When linking process ends, it will appear "LINKED TO A NEW RECEIVER".
- There is another way to link together 41514 and 41517; it uses the PIN code printed on the labels of 41517. Press **PIN** on 41514. Then key in PIN code and press **OK**. It will appear "LINKING" on the screen. When linking process ends, it will appear "LINKED TO A NEW RECEIVER".

Once linked to a remote control (or more), Bluetooth® can only be activated from a 41514 remote control.

In case of power failure, the module will go to Bluetooth®-only mode, but it will change automatically to a full-functionality mode when any command from a linked 41514 remote control is received.

For detailed information about full-functionality mode (FM, multiroom, input, clock, alarm, sleep and Bluetooth®), please read the 41514 remote control user manual.

Troubleshooting

Problem

- Module doesn't work at all.
- The module can be linked to a Bluetooth® device, but there is no sound.
- If the module is linked to a 41514 remote control, pressing the **LINK** key switches off the sound.
- Module is powered, but it is not visible for Bluetooth® devices and do not responds to a 41514 remote control.

Possible solution

- Check that the sound unit is powered. A voltage between 115 and 230 V-50/60Hz must be applied to **L** and **N** terminals
- Check that the speakers are properly connected to **L+** / **L-** **y** **R+** / **R-** outputs. Verify the absence of short-circuits and check that the speakers line impedance is above 4 ohms. Make sure that a Bluetooth® device is connected, and set volume level to maximum.
- When **LINK** key is pressed in full-functionality mode, 41517 module goes to stand-by state to allow a new link to a different remote control. That is the reason for the music to switch off. After that, pressing any key on the 41514 regains control over the module.
- It is probable that the module is being controlled by another 41514 remote control (previously linked). Check all remote controls in the installation.

en user's manual

41514 Remote control (bluetooth®, FM/RDS, input & multiroom)

Main components

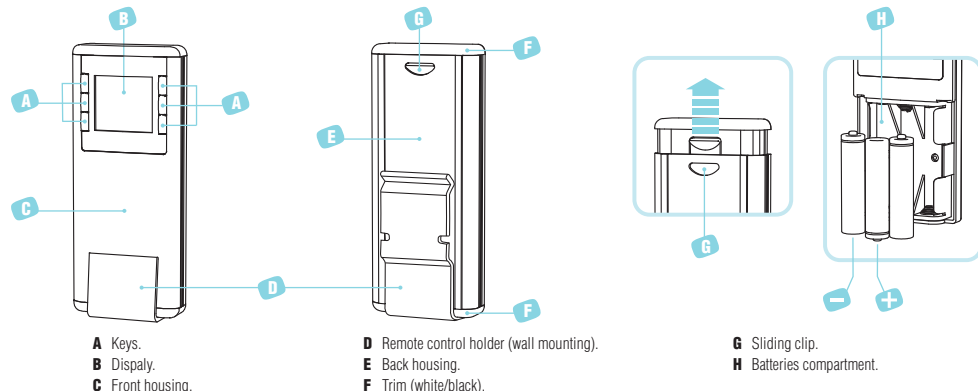

Linking and configuring 41514 & 41517 modules

The sound unit must be connected to a mains voltage between 115 and 230V ~50 / 60Hz, prior to being used.

A 41514 remote control can be linked with up to five 41517 master modules. On the other hand, a 41517 master module can be controlled by up to fifteen 41514 remote controls (it can be controlled directly in Bluetooth mode as well).

NOTE: Every command issued on the remote control 41514 is performed effectively on the 41517 master module.

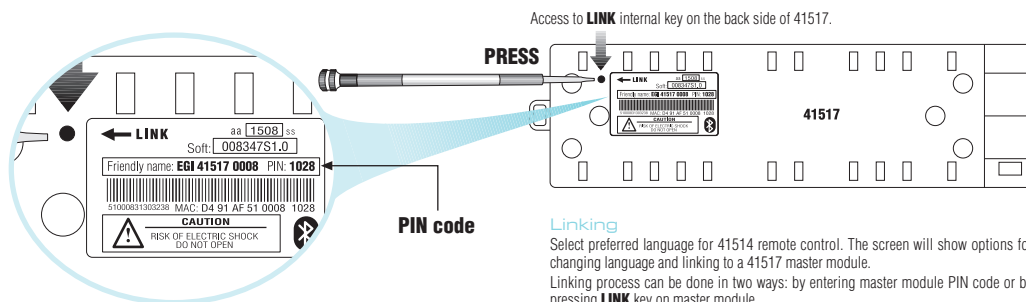

Entering PIN code:

Press PIN key and enter PIN code by means of four upper keys.

Master module PIN code is printed on a label attached to the back housing. A loose label with PIN code is supplied as well for user convenience.

Once PIN code has been entered, press **OK** key. During the linking process, **LINKING...** will appear on the screen.

When linked, it will appear **LINKED TO A NEW RECEIVER**.

From that moment on, the remote control will be able to command the master module. The remote control can be linked to a maximum of four additional master modules by entering LINKS menu.

In case of linking process fail, the remote control will show linking options again. Please check PIN code is entered correctly.

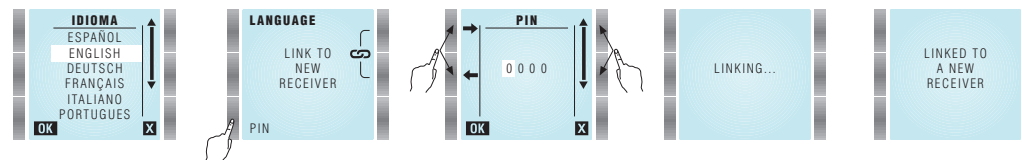

Pressing LINK key:

By using a small screwdriver or a clip, press shortly once on **LINK** internal key of the master module to be linked.

Press at the same time the two keys for 0.5 s on the remote control. You have a minute to do that. During the linking process, **LINKING...** will appear on the screen. When linked, it will appear **LINKED TO A NEW RECEIVER**.

From that moment on, the remote control will be able to command the master module. The remote control can be linked to a maximum of four additional master modules by entering LINKS menu.

In case of linking process fail, the remote control will show linking options again. Please check **LINK** key is pressed, and press again the two keys at the same time on the remote control.

NOTE: If a remote control is linked to a master module, further linking attempts will be unsuccessful. If necessary, a link can be deleted by entering LINKS menu and selecting REMOVE.

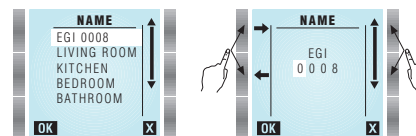
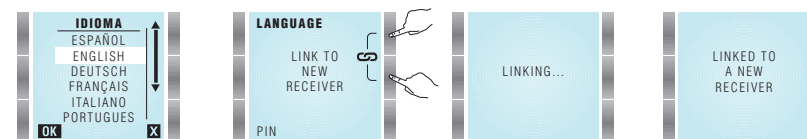

Configuration

After linking, it will appear a list with suggested names that can be assigned to the master module. The master module current name is at the top of the list.

Any name is editable by selecting it and pressing **OK**. A number can be added (i.e. BEDROOM2), or it can be changed as desired.

The master module chosen name will become its Bluetooth® Friendly Name too.

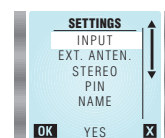

After choosing the name, it will appear the SETTINGS menu. The first item asks if an audio source is connected to INPUT terminals, select YES or NO accordingly.

The module takes the FM signal from the mains cable by default. In case of bad reception, enter EXT. ANTEN. choose YES and connect an external antenna to the respective terminals.

Stereo or mono sound can be selected by STEREO setting.

Press **X** key (EXIT) when all the settings are done.

Operation

First connection

Press ON key .

Autoscan

AUTOSCAN option will appear. This process searches and memorizes FM radio stations.

Press **OK** to do the process or **X** key (EXIT) to continue without scanning.

Autoscan process performs an automatic search for the FM* stations with best reception and obtains RDS data (this operation can take up to 2 minutes approximately).

(*) Up to 30 stations + 6 in manual mode.

Autoscan process can be done at any time by entering MENU and selecting AUTOSCAN.



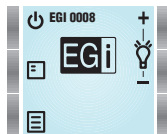

Main screen

Turn on/off the device

Press key to turn on/off the device.

When the module is off, backlighting intensity can be adjusted by means of **+** and **-** keys. It affects only to the backlighting when the module is off.

NOTE: In case of power failure, when the module is turned on again, RADIO mode will be selected.



Volume adjustment

When the module is on, volume level can be adjusted by means of **+** and **-** keys.

A short press changes the volume step by step, whereas a long press changes it at an accelerated rate.

NOTE: This function is available when an audio source is activated and the remote control is at the idle screen.



FM List

Press **FM** key to see all tuned stations.

Use **▲** and **▼** keys to select a station and press **OK** to listen to it. Normally, station name is displayed. If the station does not send RDS information, station frequency is displayed instead.

Press **★** key to add stations to FAVOURITES list.

Press **★** key again to remove a station from FAVOURITES list.

To remove a station from FM LIST, select it and press **⌫** (REMOVE).

It will be erased permanently.

To recover an erased station, it must be tuned later by using MANUAL FM.

Press **X** key (EXIT) to quit menu at any moment.

Favourites list

It can be selected up to 6 favourite stations.

Press **★** at FM LIST to choose them. Selected station will be added to favourites list at the first free location.

A station can be added at FAVOURITES **★** by using **▲** and **▼** keys to select a free location and then **FM** key. This way a list of available stations will appear, from which the desired station can be added to FAVOURITES **★**.

To remove a favourite station from the list, select it using **▲** and **▼** keys and press **⌫** key (REMOVE).

Main MENU (to enter it, press MENU key)

TIME

Internal clock can be adjusted automatically (by synchronizing it to a station with RDS time information) or manually.

If AUTO mode is selected, time information will be restored automatically after a power failure.

Automatic setting:

From TIME menu select AUTO.

Press **FM** key and choose a station that offers RDS time information (usually state stations).

Wait 1 or 2 minutes for the clock to synchronize and press **OK**. If current time is not displayed, switch to other station.

Manual setting:

From TIME menu select MANUAL.

Use **+** and **-** keys to modify hours value (HOURS is highlighted).

Then, press **▼** key to adjust minutes the same way as hours. When all is correct, press **OK** key.

Once the clock is set, **OK** key will be replaced by **■** key in TIME menu.

If **■** key is pressed, time will not be displayed anymore.

12-24 hours mode:

To change time display mode, press **▼** key to highlight 12/24H.

Then press 12/24H to choose the desired option. Press **OK** to validate.

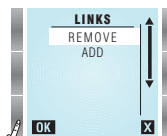
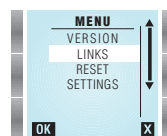
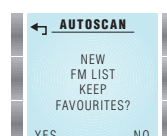
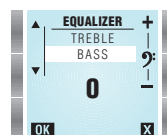
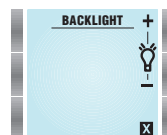
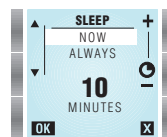
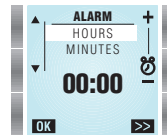
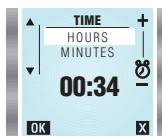
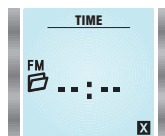
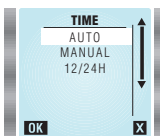
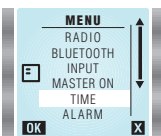

ALARM

To set the alarm, highlight ALARM from main menu by using **▲** and **▼** keys and press **OK**.

Use **+** and **-** keys to modify hours value (HOURS is highlighted).

Then, press **▲** and **▼** key to adjust minutes the same way as hours.

Press **⏸** key (MORE) to select alarm type.

Alarm volume will be set at the same level that it was when configured.

By means of **⏮** and **⏭** keys, following options can be chosen: FM radio once , Buzzer once , FM radio every day or Buzzer every day .

When all is correct, press **OK** key.

Activation time and alarm type will be shown on main screen.

When alarm is triggered, it can be turned off by pressing STOP (stop alarm) or SNOOZE (repeat every 9 minutes).

If not turned off, alarm will stop after 10 minutes.

To delete the alarm, select ALARM from the main menu and press **⌫** key.

SLEEP (TIMER)

To set the timer, highlight SLEEP from main menu by using **▲** and **▼** keys and press **OK**.

Use **▲** or **▼** to select whether the timer will be activated once (NOW) or every time the module is turned on (ALWAYS).

Use **+** and **-** keys to adjust turn off time.

Press **OK** to save the settings.

Select 0 minutes to deactivate SLEEP function.

LIGHTING CONTROL

Lighting when the module is on:

To adjust screen lighting level, highlight BACKLIGHT from main menu by using **▲** and **▼** keys and press **OK**.

Lighting level can be modified by using **+** and **-**. Press **X** (EXIT) to save the setting.

Lighting when the module is stand-by:

Lighting level can be modified by using **+** and **-** keys.

When the module is off, the screen can be completely darkened.

EQUALIZER

To adjust bass and treble, highlight EQUALIZER from main menu by using **▲** and **▼** keys and press **OK**.

Use **▲** or **▼** to select bass or treble .

Once selected, press **+** or **-** to increase or decrease bass or treble level.

When adjusted press **OK** to save and quit, or **X** to quit without saving.

MANUAL FM

To tune manually a station, highlight MANUAL FM from main menu by using **▲** and **▼** keys and press **OK**.

Tuning frequency can be increased or decreased in 100 KHz steps by pressing **⏮** or **⏭**.

To perform an automatic search, press **⏮** or **⏭** to find the next higher/lower frequency station (signal level must be over a certain threshold).

When a station is found (both in auto and manual mode), after some seconds RDS* information will appear.

Sometimes this information is changing, press **OK** when it is displayed the information you want to associate with the station. The station will be added to FM list (if there is any memory available).

It can be stored up to 36 stations (30 from autoscan + 6 from manual tuning).

(*) Not all the stations transmit RDS information, if RDS text does not appear, press **OK**.

AUTOSCAN

To activate automatic station search, highlight AUTOSCAN from main menu by using **▲** and **▼** keys and press **OK**.

A new FM station list will be created. Favourites list can be kept or deleted.

Autoscan process can take several minutes.

Press **⏮** to quit without doing autoscan.

LINKS

LINKS menu allows 41514 remote control to be linked to other 41517 master modules.

Up to 5 master modules can be linked. A remote control can manage 5 rooms and even change its name. However, a 41517 master module can be linked with up to 15 remote controls.

Concretely, this menu allows deleting or adding links to 41517 master modules.

To do that, follow these instructions.

- To enter LINKS menu, highlight LINKS from main menu by using **▲** and **▼** keys and press **OK**.
- To add a new master module press ADD option. It will appear a new screen with two methods of linking: PIN entering or pressing **LINK** key on master module (see **LINKING** section).
- To change master module name, go to main menu, select SETTINGS and then select NAME.
- To remove a link to a master module, press REMOVE.
- Then a list of linked modules will be displayed. Select the module to be removed. Press **X** key (EXIT) to quit without removing any link.

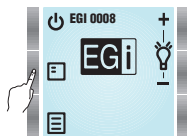

HOW TO SELECT THE MASTER MODULE TO BE CONTROLLED:

If the remote control has been linked to more than one master module, it can be chosen which master module is commanded by the remote control.
See "How to change the master module to be controlled by 41514 remote control" below.

• LANGUAGE

To select menu language, highlight LANGUAGE from main menu by using ▲ and ▼ keys and press **OK**.
Use ▲ and ▼ to select the desired language and press **OK**.

• VERSION

To know device firmware version, highlight VERSION from main menu by using ▲ and ▼ keys and press **OK**.
It will appear: software version, serial number and other service information. (SW – stands for software version and HW – stands for hardware version).

• RESET

To reset the master module configuration to factory settings, highlight RESET from main menu by using ▲ and ▼ keys and press **OK**. User will be prompted to confirm action (press **OK**) or to quit without executing reset (press **X**).
IMPORTANT: Personal configurations, FM list and Favourites list will be erased by resetting.

• SETTINGS

To change the settings, highlight SETTINGS from main menu by using ▲ and ▼ keys and press **OK**.

INPUT:

If an audio source is connected to INPUT terminals, select YES. Select NO otherwise (INPUT option will not appear in main menu in this case).

EXT. ANTENNA:

Press ▲ and ▼ keys on the right to select EXT. ANTEN.
Use ▲ and ▼ keys on the left to select external antenna (YES) or internal antenna (NO).
Internal antenna use (NO) is recommended.

In case of interferences from the mains (caused by other devices like electronic ballasts) or bad reception, use external antenna (YES).

STEREO:

Press ▲ and ▼ keys on the right to select STEREO.
Use ▲ and ▼ keys on the left to select stereo mode (YES) or mono mode (NO).



• PIN

This option allows changing BLUETOOTH PIN. It is factory preset to the value printed on the labels, but it can be changed to any desired 4 digit code.

Highlight PIN from SETTINGS menu and press **OK**.

Use the 2 top keys on the left to select the digit.

Use the 2 top keys on the right to change the digit.

Press **OK** to validate the new PIN, or press **X** to quit without modifying it.

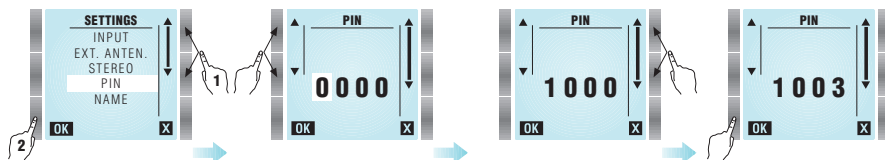

How to change the master module to be controlled by 41514 remote control

41514 remote control can command several master modules. The master module to be controlled can be selected from both stand-by screen and main menu screen.

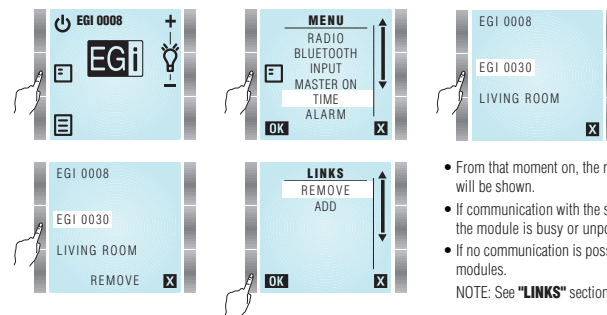

- Press **E** key to show the name of the master modules the remote control is linked to.
- Press the key next to the name of the module to be controlled.

- From that moment on, the remote control will command the selected master module, and its main screen will be shown.
- If communication with the selected master module is not possible (either by loss of coverage or because the module is busy or unpowered), the remote control will return to the list of linked modules.
- If no communication is possible, the remote control will offer the possibility of removing or adding master modules.

NOTE: See "LINKS" section for details.

Bluetooth®

IMPORTANT: It is recommended changing module Friendly Name and PIN prior to use Bluetooth®, in order to differentiate it from other nearby devices. Select SETTINGS from main menu to do it.

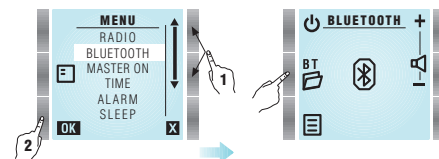

NOTE:

In case of power failure or if Bluetooth® mode is quit and re-entered quickly, it could take 14 seconds for the BLUETOOTH® function to be available. In the meantime **X** symbol will be displayed.

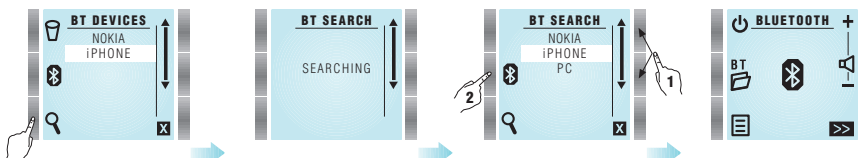

- Press **Q** to find new devices. They will be displayed after around one minute.
- Select the device to be paired with, and press **Q**.
- The paired device will ask for a PIN code. If it has not been changed, the value to be entered is printed on the module labels.

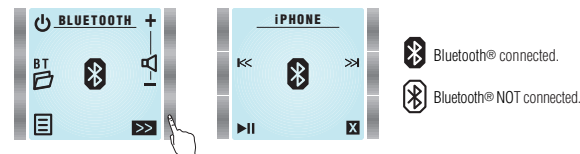

- Once the Bluetooth device is connected, user will be able to listen to the music, to change volume or to control music playing. It can be done either form the device or from the remote control.
- When **>>>** key is pressed, module enters remote player mode.
Press **▶** to jump to the next song.
Press **◀** to jump to the previous song.
Press **⏸** to play/pause the music.

- To unpair a device (i.e. delete it form paired devices list), enter **BT** (BT DEVICES), select the device to unpair with and press **Q** key. The pairing can be also deleted from the device (smartphone, PC, tablet, laptop...).
- Enter SETTINGS menu to change PIN.
- Module Friendly Name is factory preset to ("EGI 41517 _ _ _ _") stands for a four digit unique identifier. These codes are printed on a label on the back of the module and on another loose label.
- Enter SETTINGS menu to change NAME.

Multiroom

NOTE: It is necessary to wire multiroom BUS (connection blocks 4, 5 and 6) to all 41517 modules in the installation, in order to use MULTIROOM option. This option allows the user to share the selected music on one module to the rest of the modules in the installation. To do that, follow the next steps:

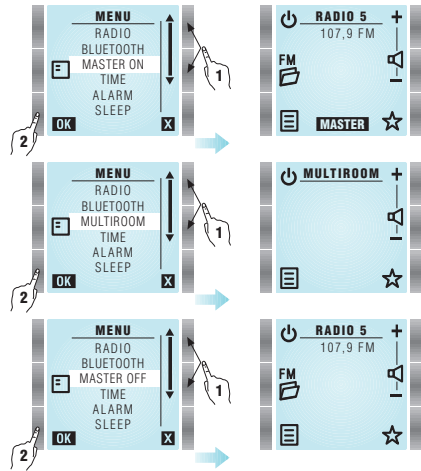

- Select the module which will distribute the music to the others (and choose its desired audio source).
- Highlight MASTER ON from main menu by using ▲ and ▼ keys and press **OK**.

- When a module is switched on, it automatically selects MULTIROOM audio source (i.e. the music from MASTER module).
In case the module is turned on yet, go to main menu and select MULTIROOM source.
To exit MULTIROOM mode, choose another audio source from main menu or turn off the module.

- To exit master mode, select MASTER OFF from main menu.
The module will no longer distribute music and all the modules in MULTIROOM mode in the installation will turn off.

Input

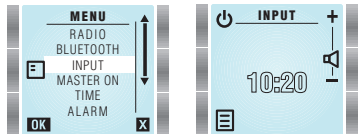

- To select the audio INPUT source, select INPUT from main menu.
Once selected that source, its volume level can be controlled by + and - keys.
- Another audio source can be selected from main menu.
- To turn off the module, press ⏻ key.

Troubleshooting

Problem

- Module doesn't work. The screen is off.
- The screen is on, but there is not any sound.
- Bad FM reception.
(41517 master module uses mains cable as antenna. In case of interferences or weak signal, please connect an external antenna and change antenna selection in SETTINGS menu accordingly).
- A bluetooth® device is not seen from the module.
- Time is not recovered automatically after a power failure. It shows blinking dashes instead of the time.
- Time is not displayed on the screen.
- 41514 remote control losses communication with 41517 master module and shows the following screen:



Possible solution

- Press any key to get a response.
- Check batteries status.
- Check that a valid audio source is selected and it is playing some music.
- Check volume level is not at minimum.
- Check that the speakers are properly connected to the connection block.
- Connect an external FM antenna by using coaxial cable or check that it is properly connected.
- Check antenna settings to see if antenna selection is correct.
- Ensure that the module is not close to electronic ballasts or similar equipment (fluorescent lamps...).
- Check that the device has bluetooth® function enabled and it is configured as visible to other devices.
- Check that time is configured to AUTO mode and a valid FM station is selected (it must transmit time information by using RDS).
- Configure time settings to AUTO mode, so it can recover time information automatically after a power failure.
- Check that TIME is not disabled.
- Set the clock in manual or auto mode.
- Verify that 41517 master module (placed on the ceiling) is properly powered (115 V~ / 230 V~).
- Press X key (EXIT), so that the remote control can retry a communication.
- Press REMOVE to delete previously linked master modules, or press ADD to memorize a new master module.

play & sound[®]

WALL RADIO AIR RADIO

national

Avda. Almozara, 79
50003 Zaragoza - ESPAÑA
Tel. 976 40 53 53
Fax 976 40 53 54
<http://www.egiaudio.com>
e-mail: info@egiaudio.com

export

Av. Almozara, 79
50003 Saragossa - SPAIN
Tel. +34 976 40 53 56
Fax +34 976 40 53 54
<http://www.egiaudio.com>
e-mail: export@egiaudio.com



Electroacústica
General
Ibérica, S. A.



RoHS

